

VAYA

GB

ELECTRIC SCOOTER VAYA V9

USER GUIDE

PO-1684

CONTENTS

BEFORE YOU START	4
WARNINGS AND CAUTIONS	4
BOX CONTENTS	5
OVERVIEW	5
PLEASE READ THE FOLLOWING INSTRUCTIONS CAREFULLY	6
GETTING STARTED.....	6
ASSEMBLY.....	6
FOLDING.....	7
UNFOLDING.....	7
CARRYING THE E-SCOOTER.....	8
DISPLAY.....	8
OPERATING PRINCIPLES	9
START.....	9
OPERATION.....	9
HOW TO RIDE YOUR E-SCOOTER.....	9
WEIGHT AND SPEED LIMITATIONS	9
WEIGHT RESTRICTIONS.....	9
SPEED LIMITS.....	10
OPERATING RANGE	10
BATTERY INFORMATION AND SPECIFICATIONS.....	10
BATTERY POWER	10
BATTERY SPECIFICATIONS.....	10
CHARGER SPECIFICATIONS.....	10
CHARGING YOUR SCOOTER.....	11
INSPECTION, MAINTENANCE, CLEANING AND STORAGE.....	11
INSPECTING YOUR SCOOTER	11
ADJUSTING THE DISC BRAKE.....	12
FINE-TUNE THE BRAKE CABLE TENSION	12
NOISE FROM THE BRAKE	12
ADJUSTING THE FOLDING MECHANISM	13
CLEANING YOUR SCOOTER	13
STORING YOUR SCOOTER	13
SCOOTER SPECIFICATIONS.....	13
SYMBOL EXPLANATION	14
DISPOSAL	14

BEFORE YOU START

Before you use the E-Scooter for the first time, please read the USER MANUAL thoroughly and follow the instructions and warnings to ensure your own safety and the safety of others. It is recommended to keep the instruction manual for future reference. For further information visit www.envivo.nu

WARNING: Failure to follow the basic instructions and safety precautions listed in the USER MANUAL, can lead to damage to your scooter, other property damage, serious bodily injury, and even death.

WARNINGS AND CAUTIONS

1. Recommended age use 14+ years.
2. The battery charger may be used by children aged from 8 years and above and persons with reduced physical, sensory or mental capabilities or lack of experience and knowledge if they have been given supervision or instruction concerning use of the appliance in a safe way and understand the hazards involved.
3. Children should be supervised to ensure that they do not play with the appliance. Cleaning and user maintenance shall not be done by children.
4. If the charger supply cord is damaged, it must be scrapped, and the charger replaced by the manufacturer or its service agent – please contact the service line.
5. Do not attempt to modify, change or replace your battery or any other part of the unit.
6. Users who disassemble the scooter will forfeit their right of warranty.
7. Only use the charger included in the box. The scooter must only be supplied at safety extra low voltage corresponding to the marking on the scooter.
8. The included charger is only to be used with this E-scooter and not with any other electronic equipment. Do not use the charger to charge any non-rechargeable batteries.
9. Please wear all appropriate safety and protective gear while operating the scooter. See the operating principles section for more information.
10. Make sure to wear comfortable clothes and flat closed-toe shoes when operating your scooter.
11. Do not use the scooter to place yourself or anyone else and their property in danger.
12. Do not operate the scooter while under the influence of drugs and/or alcohol.
13. Use your best judgment to keep yourself out of dangerous situations with your scooter.
14. Do not attempt any stunts or tricks with your scooter.
15. Do not turn sharply, especially at high speeds.
16. Do not abuse your scooter, doing so can damage your unit and cause failure to the operating system which can lead to injury.
17. Do not drive in or near puddles of water, mud, sand, stones, gravel, debris or near rough and rugged terrain.
18. The scooter can be used on paved surfaces that are flat, clean, dry and where possible, away from other users. If you encounter uneven pavement, please lift your scooter over and past the obstruction.
19. Do not ride in darkness.
20. Disc brake will be hot after use: do not touch after braking.
21. If the handlebar grips become damaged and expose the metal ends of the handlebar, these must be capped using internally fitted "bar end plugs".
22. Do not ride in inclement weather. snow, rain, hail, sleet, on icy surfaces or in extreme heat
23. For operating the scooter through bumps and uneven pavement- Bend your knees when riding on bumpy or uneven pavement to absorb the shock and vibration and help you to keep your balance. If you are unsure if you can safely ride on a specific terrain, step off and carry your scooter. ALWAYS BE ON THE SIDE OF CAUTION.
24. Do not attempt to ride over bumps or objects greater than 1.5 cm even when prepared and bending your knees.
25. PAY ATTENTION - look at where you are riding and be aware of the surfaces conditions, people, places, property and objects around you.
26. Do not operate the scooter in crowded areas.
27. Operate your scooter with extreme consideration for people and property at all times.
28. Do not operate the scooter while talking, texting, or looking at your phone.
29. Do not ride your scooter where it is not permitted.
30. Not intended for use on public roads in all nations: check the limitations of use according to regulations of road safety.
31. Do not climb or travel down steep hills with your scooter.
32. The scooter is intended for use by a single individual, DO NOT attempt to operate the scooter with two or more people.
33. Do not carry anything while riding the scooter.

34. At higher speeds, always take into consideration longer stopping distances.
35. Do not attempt to jump on or off your scooter while driving.
36. Do not use for off-road driving.
37. Do not exceed the maximum weight limit (120 kg).
38. These instructions are available from the service address at the base of the page.

It is recommended to keep the original box in the unlikely event that you need to return the product to us or send it in for repair.

WARNING: the warranty does not cover improper use of the product or the failure of users to follow the warnings and operation instructions in this user guide. Furthermore, there is a limited warranty on parts that are subject to normal wear and tear, such as wheels, battery, brakes, rear fender and grips. These parts are considered wear and tear parts and can subsequently be ordered at www.envivo.nu

BOX CONTENTS



E-scooter

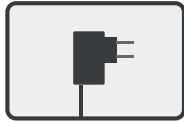

Charger



User Guide



Hex-key tool



4 x screws

OVERVIEW

1. Throttle
2. Display
3. Folding grip
4. Bell
5. Hand brake
6. Headlight
7. Safety pin
8. Folding lock
9. Charging port
10. Disc brake
11. Rear fender hook
12. Rear light
13. Battery and controller
14. Kickstand
15. Front motor
16. Front suspension
17. Rear suspension

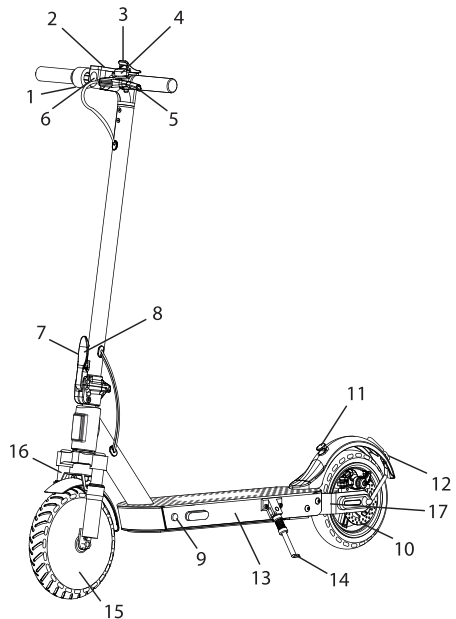

PLEASE READ THE FOLLOWING INSTRUCTIONS CAREFULLY

Step 1: Getting started – Take your scooter out of the box and place it flat on the floor.

Step 2: Charging your scooter – Make sure the scooter is fully charged before your initial use. For charging instructions, please follow details under the battery and charging specifications.

Step 3: Wear all proper safety gear, including but not limited to a helmet, knee pads, elbow pads and wrist guards.

GETTING STARTED

ASSEMBLY

Attach the handlebar. Insert the screw and tighten them using the included hex-key.

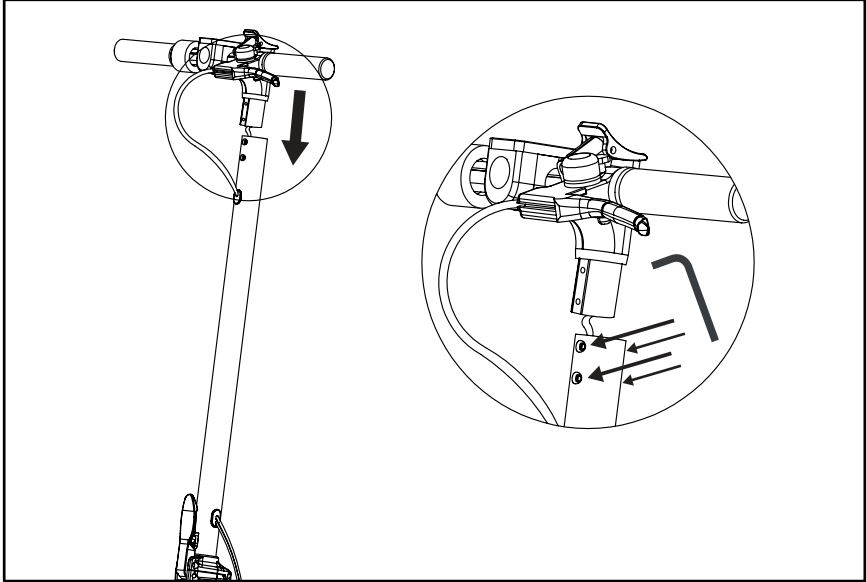

WARNING: The 4 screws keep the handle attached to the front bar so important that they are securely attached. Do not use too much force when securing the screws. Check if screws are attached every time you use the e-scooter.

FOLDING



Push the safety pin upwards to open the folding lock.



Pull the folding lock outwards to fold the e-scooter.



Gently bring the steering column down.



Click the folding grip onto the rear fender hook.



UNFOLDING

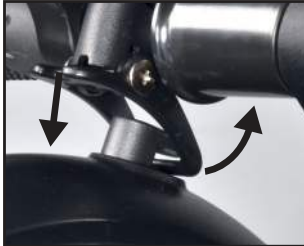

Push the folding grip down and gently bring the steering column all the way up.



Push the folding lock towards the steering column to lock it.



WARNING: Before riding the E-Scooter always check that the locking mechanism is fully locked.

CARRYING THE E-SCOOTER

Pick up the e-scooter gently to avoid putting too much load on the rear fender.

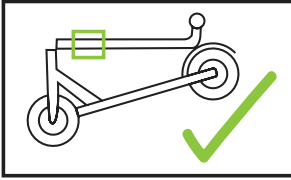

Position hand here when carrying

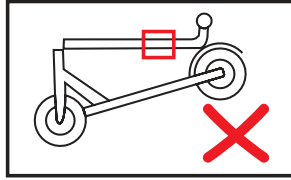

Avoid lifting e-scooter here

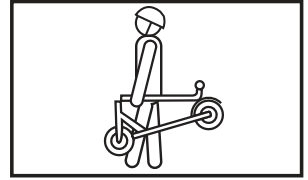

DISPLAY

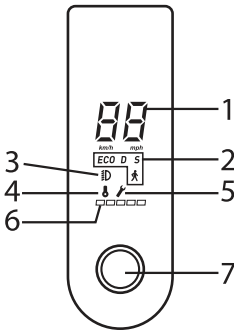

1. Speed

Shows the current speed you are traveling at.

2. Riding mode

Change between different driving styles.

-  Walk mode. Drives up to 6 km/h.
- ECO: Economy mode. Drives up to 10 km/h.
- D: Drive mode. Drive up to 20 km/h.
- S: Sport mode. Drive up to 25 km/h.

3. Light indicator

Light up on display when front light and rear light is turned on.

4. Overheat indicator

Light up if the temperature of the controller exceeds 80 °C.

5. Device fault indicator

Contact service center.

6. Battery level indicator

Battery (100%) will show 5 bars.

Please remember to charge your battery when it is on its last bar. As the battery depletes, the strength of the motor will get weaker.

7. Display button

OPERATING PRINCIPLES

START

The E-scooter comes with a security lock that you need to unlock before you can use the E-scooter.

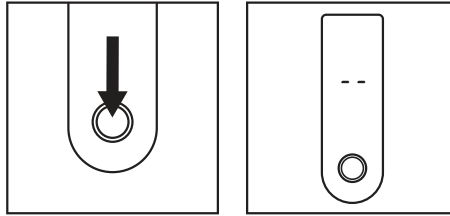

Press and hold the display button for 2 seconds to turn the scooter ON.

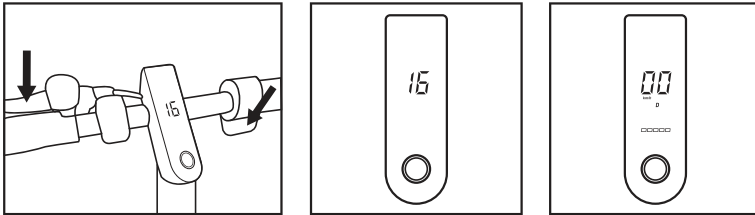

To unlock the E-Scooter press and hold down the accelerator. The display will show "16". While holding down the accelerator, press down the brake handle. The display will now show the driving speed and battery indicator. Release the accelerator and brake handle.

The E-scooter is now ready to ride.

To ride the E-scooter push the e-scooter forward while holding down the accelerator. The E-scooter does not accelerate from a stationary position.

Press and hold the display button for 2 seconds to turn the scooter OFF.

OPERATION

- Short press the display button to turn the lights ON or OFF.
- Hold down the accelerator and then the brake handle to unlock the E-scooter.
- Double click the display button to change gears.
- The rear light flashes when you use the hand brake.
- The E-scooter will automatically power off when not used for 15 minutes.

HOW TO RIDE YOUR E-SCOOTER

- Switch on and unlock the scooter.
- Stand with one foot on the footboard.
- The throttle is located to the right on the handlebar. Press the throttle down and push the e-scooter forward to accelerate and release it to decelerate.
- The hand brake is located to the left on the handlebar, press the lever progressively to decelerate.

WEIGHT AND SPEED LIMITATIONS

WARNING: Speed and weight limits are set for your own safety. Please do not exceed the limits listed in the user manual.

WEIGHT RESTRICTIONS

Maximum weight: 120 kg

SPEED LIMITS

Maximum speed: 25 kmh.

OPERATING RANGE

Please note that the scooter can travel 22 km on a fully charged battery in ideal conditions. The following are some of the major factors that will affect the operating range of the scooter.

Terrain: A smooth flat surface will increase your riding distance, whereas riding uphill or on rough or uneven terrain will reduce your distance significantly.

Weight: The weight of the user can affect the riding distance; a lighter user will have a farther range than a heavier user.

Ambient temperature: Please ride and store the scooter at the recommended temperature, which will increase riding distance, battery life and overall performance of your scooter.

Maintenance: Correct battery charging, and maintenance will prolong the battery life.

Speed and riding Style: Maintaining a moderate speed will increase your distance; while traveling at high speeds for extended periods, frequent starts, stops, and idling, along with frequent acceleration and deceleration will reduce your overall distance.

BATTERY INFORMATION AND SPECIFICATIONS

This section is intended to provide you with the basic information about your battery and charger. Please read this section carefully to ensure your safety. For user safety and to prolong the life of your battery, as well as improve battery performance, please follow these instructions.

BATTERY POWER

When the battery indicator shows a low battery, please charge your E-scooter's battery using the supplied charger. To fully recharge your battery, please follow the instructions under "Charging your scooter".

BATTERY SPECIFICATIONS

Battery: 30*18650 Lithium-ion battery pack

Model: CHY3775E041058

Charging time: 5 hours

Voltage: 36V

Battery cells: 30 cells

Initial capacity 7.5Ah

Working temperature: 0° ~ 40°

Charging temperature: 0° ~ 40°

Storage time: 6 months

Storage temperature: 0° ~ 45°

Storage humidity: 5% - 95%

CHARGER SPECIFICATIONS

Model number: GA20-4201500T

Input: 100-240V, 1.8A, 50-60Hz

Output: 42V = 1.5A

CHARGING YOUR SCOOTER

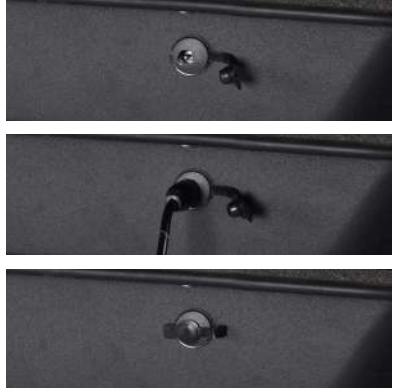
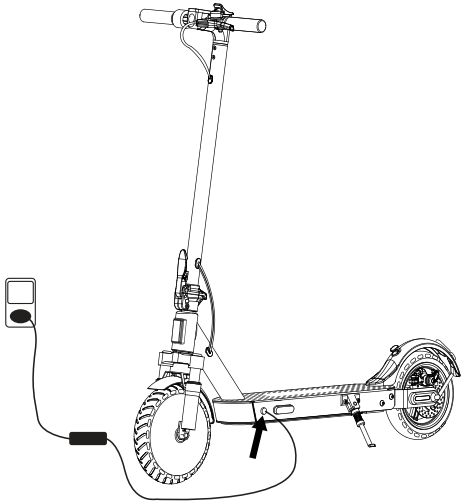

Step 1: Ensure that the charging port is clean and dry.

Step 2: Plug the charger into a power outlet, then connect the cable with the power supply (100V ~ 240V; 50,60 Hz), make sure the light on the charger is lit GREEN.

Step 3: Connect the charging cable to the charging port of the scooter. The indicator light on the charger should turn RED, indicating that your scooter is now being charged. When the indicator light on the charger turns from RED to GREEN, your scooter is fully charged. The charger will automatically stop charging when the light turns GREEN.

Step 4: Disconnect the charger from the scooter and the power outlet.

Note: If the GREEN light on the charger does not turn RED when you connect the charger to your scooter, check that all the connections are properly made or that the scooter is not already fully charged.

WARNING: Remember to insert the charger rubber cover after every charge to protect it from water and dirt.

INSPECTION, MAINTENANCE, CLEANING AND STORAGE

Your scooter requires routine inspection and maintenance. This chapter describes maintenance steps and important operating tips. Before you perform the following operations, ensure the charging cable is disconnected.

ATTENTION: Failure to follow the maintenance, cleaning and storage instructions can result in damage and corrosion that can void the warranty claim.

INSPECTING YOUR SCOOTER

Each time before you ride the scooter:

- Check that the front wheel is properly aligned and connected to the handlebars. Position the front wheel between your feet and gently move the handlebar from side to side to check that the wheel follows the handlebars. If you find any problems, contact after sales support.
- Check that the E-scooter is correctly unfolded before riding.
- Check if the brake pads are worn out. If the brake pad is worn out (approximately less than 1 mm left) then they need to be replaced immediately.

The E-scooter is subject to a lot of vibrations. Routinely check the body of the scooter and tyres for damage or excessive wear. Check all bolts and screws and tighten them if needed. Double check screws around the folding mechanism and the wheels.

Note: If a fault or damage occurs in the scooter, you must immediately stop using the product and contact after-sales support for assistance. Any further damage or fault that occurs because of the use of a damaged product will nullify the warranty.

ADJUSTING THE DISC BRAKE

If the brakes are too tight or too loose then use the included hex-key on the bolt that holds the brake cable in position. Loosen the bolt.

To tighten the cable tension: Decrease the length of the brake cable.

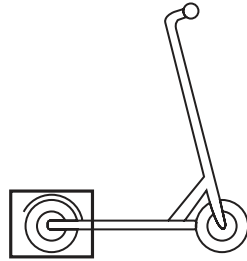
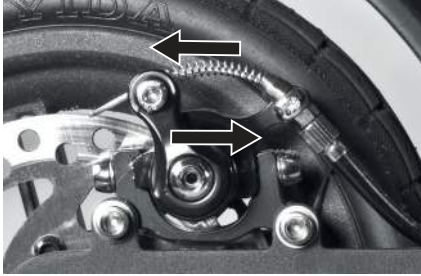

To loosen the cable tension: Increase the length of the brake cable.

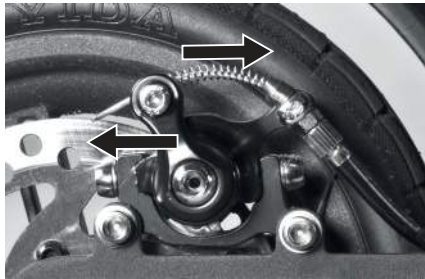

FINE-TUNE THE BRAKE CABLE TENSION

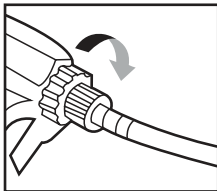

To tighten the cable tension, turn counter clockwise.

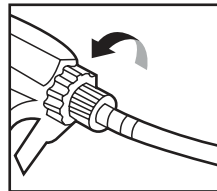

To reduce the cable tension, turn clockwise.

NOISE FROM THE BRAKE

- Brake disc needs to be cleaned.
- Brake pads need to be cleaned or grinded down.
- Brake pad is worn out and need to be replaced.
- Brake disc is damage. Try slightly bending it away from where it touches the brake pads.

ADJUSTING THE FOLDING MECHANISM

Use the supplied hex-keys to tighten the 3 screws around the folding mechanism when needed.

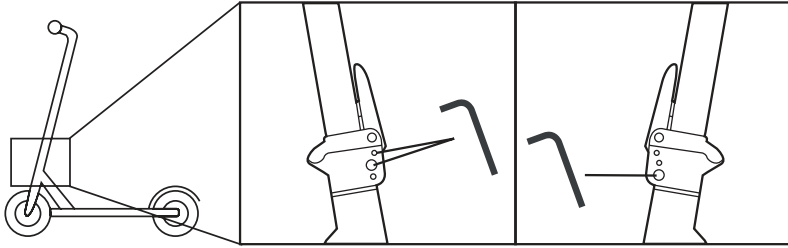

CLEANING YOUR SCOOTER

Disconnect the charger and turn off your scooter.

Avoid using water or other liquids and cleaners on the scooter while cleaning. Wet a clean cloth with clean soapy water, wring out the cloth thoroughly, and wipe the body of the scooter. Make sure that water does not get into the display button, charging port, disc brake, mats, locking mechanism and tyres.

Use a damp cloth to clean the brakes and suspension springs.

Apply some acid free lubricating oil on all movable parts and the suspension springs.

If the E-scooter is wet after use, use a dry towel to wipe off the water as the water will corrode the scooter and can get into the electrical parts.

WARNING: Do not apply any oil onto the brake. Test the brake after your cleaning scooter.

STORING YOUR SCOOTER

Fully charge the battery before storing.

If you are storing your scooter for an extended period of time, please fully charge your scooter at least once every two months.

If the ambient temperature of the storage location is below 0° C, please do not charge. You must bring the scooter into a warmer environment before charging. Check the Battery Information and Specifications section for more details.

To prevent dust from getting into your scooter, try wrapping or sealing it with its original packaging.

Store your scooter indoors, in a dry location and at suitable temperatures.

SCOOTER SPECIFICATIONS

Net weight: 12 kg

Max. load: 120 kg

Max. speed: 25 kmh

Range: up to max 22 km in one battery charge

Max. climbing limit: 15°

350W motor

IPX4 Rating

Size(folded): 112 x 43 x 49 cm





Size (unfolded): 112 x 43 x 116 cm

Tyre: 8.5"

SYMBOL EXPLANATION

 Declaration of Conformity: (See provided document).
Products marked with this symbol comply with all applicable community regulations of the European Economic Area

Noise level does not exceed 70 dB

	For indoor use only.
	This unit is double insulated.
	Wear personal protective equipment.
	Read manual before operating the product.
	Class III protection against electric shock.

DISPOSAL

 Electrical and electronic equipment (EEE) contain materials, parts and substances, which can be dangerous to the environment and harmful to human health if waste of electrical and electronic equipment (WEEE) are not disposed of correctly.

Electrical and electronic equipment, which are marked with the WEEE logo (as shown on the left), should not be thrown away with your household waste. Contact your Local Authority Waste Disposal Department, as they will be able to provide details of the recycling options available in your area.

 This symbol on the battery or on the packaging indicates that the battery provided with this product shall not be treated as household waste. The recycling of the materials will help to conserve natural resources. Contact your Local Authority Waste Disposal Department, as they will be able to provide details of the recycling options available in your area.

Imported by:
Accession ApS, Vandmanden 34, 9200 Aalborg SV, Denmark.

Date of issue: 2/2022

Version: PO-1684

